

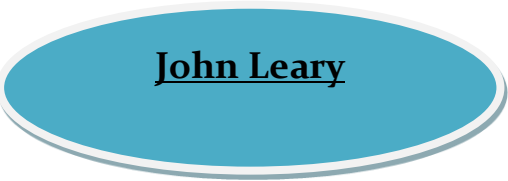

FAMILY OF: CONVICT PIONEERS

ELIZABETH SMITH (c1803-1880) - JOHN LEARY (1795-1854) – MATTHEW FLYNN (1802 -1866)

The lives of John Leary and Elizabeth Smith is interwoven with that of another convict Matthew Flynn as is summarised below:

 <p><u>Elizabeth Smith</u></p>	<p><i>English Convict – Melburn, Cambridgeshire</i> Arrived in the Colony of NSW, as a convict, per the ship "<i>Mary 3</i>" in 1823</p>
 <p><u>John Leary</u></p>	<p><i>Irish Convict – Clare, Ireland</i> Arrived in the Colony of NSW, as a convict, per the ship "<i>Princess Regent</i>" in 1824</p>
 <p><u>Matthew Flynn</u></p>	<p><i>Irish Convict – Cork, Ireland</i> Arrived in the Colony of NSW, as a convict, per the ship "<i>Tyne</i>" in 1819</p>

Elizabeth Smith
married
John Leary

Elizabeth Smith married John Leary in Sydney on 15 January, 1833 and on the same day baptised their daughter:



Catherine Leary
b 30 Dec, 1832
1 married: Jeremiah Sullivan
2 de-facto: John O'Keefe

Apparently, Elizabeth Smith and John Leary, later separated and:

- Elizabeth Leary (nee Smith) began a relationship with Matthew Flynn.

Elizabeth Smith and Matthew Flynn had 3 children:

Elizabeth Leary (nee Smith)
lived with
Matthew Flynn

Mary Ann Flynn

b 1837 at Goulburn

Sarah Flynn

b 6 Dec 1840 at Honey Flat, (Binalong?/Gunning?)

Harriett Elizabeth Flynn

b 25 March 1844 at Honey Creek, (Binalong?/Gunning?)

- After the death of her first husband John Leary

Elizabeth Leary (nee Smith)
finally, she was allowed to marry her long-time partner
Matthew Flynn
at Binalong on 18 April, 1858

Family of ELIZABETH LEARY (nee Smith) and MATTHEW FLYNN (3 daughters)

1. Mary Ann Flynn

2. Sarah Flynn

3. Harriet Elizabeth Flynn

1. Mary Ann Flynn

Mary Ann Flynn was born 1837 at Goulburn (*most likely on Mr Broughton's property on the Goulburn Plains where Matthew Flynn was employed as a shepherd*). While living on Cunningham Creek near Binalong, Mary Ann Flynn married [David Jenkins](#) at St Augustine's Roman Catholic Church, Yass on 22 August 1854.

David Jenkins / Jinkins, a native of Belfast, Northern Ireland, was a shepherd employed on the property 'Cumbamurra', a property between Binalong and Murrumburrah.

the Star.
MELANCHOLY CIRCUMSTANCE.—One of the saddest instances of a complication of accidents occurred within the last twenty-four hours. Jenkins, the driver of the mail between Binalong and Yass, left the former place for this town and arrived at the usual hour. Subsequently he received intelligence that his wife had been found burnt to death. On receiving the above news he proceeded to Mr. Carlon's farm for the purpose of catching a horse, with the view of returning home, when the animal kicked him in the right leg, inflicting a very severe flesh wound. We understand no bone was broken, but the injury received will prevent him from accomplishing his intention. When the unfortunate woman was found she was lying close to the fire-place, and although breathing there were no other appearances of animation.

A newspaper article published in the 'Yass Courier' on Wednesday 25 May 1864' leads us to a family tragedy:

MELANCHOLY CIRCUMSTANCES - One of the saddest instances of a complication of accidents occurred within the last twenty-four hours. Jenkins, the driver of the mail between Binalong and Yass, left the former place for this town and arrived at the usual hour. Subsequently he received intelligence that his wife had been found burnt to death. On hearing the sad news, he proceeded to Mr. Carlon's farm for the purpose of catching a horse, with the view of returning home, when the animal kicked him in the right leg, inflicting a very severe flesh wound. No bone was broken, but the injury received will prevent him from accomplishing his intention. The unfortunate woman when found was lying close to the fireplace, and although breathing there were no other appearances of animation. *Yass Courier, May 25, 1864.*

Mary Anne Jenkins (nee Flynn) died on 24 May 1864 at Binalong, aged 27 years. She was a domestic servant and died when her clothes caught fire. She survived 7 hours. Her death was certified by her husband David Jenkins of Binalong and registered by Jeremiah Hough on 1 June 1864 at Burrowa. *5 children - (2 boys and 3 girls)*. Mary Anne Jenkins was buried at 'Mylora' Cemetery near Binalong. Francis Gannon was the undertaker.

SERIOUS BOILER EXPLOSION AT CUMBAMURRA.—Among the modern improvements in sheep-washing that of using tepid water in place of cold has proved most beneficial to the interests of flock-masters. We believe that Mr. J. D. Macansh, of Kitticarra, was the first to introduce into our part of the colony this method of cleansing wool while on the sheep's back. Some time past he erected at his station at Cumbamurra a large boiler for this purpose. The water was conveyed by tanks to the soaking pen, and there can be little doubt that this process of separating grease and grit from the wool contributed largely towards the celebrity which Mr. Macansh's wools have attained. Unfortunately on last Tuesday afternoon, through want of proper attention on the part of the person in charge the boiler, which was of considerable dimensions, burst, and such was the power of the steam as it escaped that large fragments of it were carried to a distance of upwards of fifty yards. At the time of the accident a flock of sheep were in course of being washed and there were about one hundred of the number to finish. By the explosion five or six men were thrown headlong into the soaking pen. Mr. Edmonds, the superintendent was stunned, and received a severe cut over the eye with several contused wounds; bricks in which the boiler had been imbedded were carried to a long distance off but the most serious consequence of the accident were the injuries sustained by a man named Jenkins and two others. Jenkins was seated on the brick wall at the time of the occurrence, and was hurled head downwards into the pen, receiving at the same time a perfect flood of the boiling water over his back and sides. The two other men were also much injured, and it was considered necessary that the three sufferers should be sent to the Yass hospital for medical treatment, a distance of sixty miles, as it was alleged that no medical man could be procured nearer at hand. We are informed that the stoker had kept up a large fire in the furnace from the time the men went to dinner until the accident happened, and had neglected to pump into the boiler a sufficient quantity of water. The three sufferers are now in the hospital, but we believe that the injuries they have received are not likely to prove fatal. Jenkins was some time since the driver of the mail between Yass and Binalong, and resided with his wife at the latter place. While absent from home and employed in catching a horse, he received a most severe kick from the animal, which although it broke no bone caused a frightful flesh wound. During the time he was laid up news reached him from Binalong that his wife had been burnt to death while in a state of intoxication. A correspondent supplies us with the following: It was an eighteen foot boiler; there were thirteen men near it at the time of the accident and only two escaped without receiving some injury, more or less severe. The top of the boiler was blown into two pieces and carried one hundred feet off; one of the pieces was driven edgewise into the ground and bounded out again. It was built into brick work on a stone foundation, not one brick remained on the top of another nor yet one stone. None of the sheep were injured. The men who were thrown into the soaking-pen were dragged out quickly with the exception of one who was not at first observed. He was, however, rescued just in time to save his life. He had been struck on the head, stunned, and immediately sank. *Yass Courier.*

After losing his wife in May 1864, David Jenkins was to meet with an unfortunate accident as reported in:

'The Empire (Sydney)', Saturday 3 December 1864 [extracted from the 'Yass Courier']

SERIOUS BOILER EXPLOSION AT CUMBAMURRA – Among the modern improvements in sheep-washing that of using tepid water in place of cold has proved most beneficial to the interests of flock-masters. We believe that **Mr. J. D. Macansh**, of Kitticarra, was the first to introduce into our part of the colony this method of cleaning wool while on the sheep's back.

Sometime past he created at his station at **Cumbamurra** a large boiler for this purpose. The water was conveyed by tanks to the soaking pen, and there can be little doubt that this process of separating grease and grit from the wool contributed largely towards the celebrity which Mr. Macansh's wools have attained. Unfortunately on last Tuesday afternoon, through want of proper attention on the part of the person in charge the boiler, which was of considerable dimensions, burst, and such was the power of the steam as it escaped that large fragments of it were carried to a distance of upwards of fifty yards. At the time of the accident a flock of sheep were in course of being washed and there were about one hundred of the number to finish. By the explosion five or six men were thrown headlong into the soaking pen. Mr. J Edmonds, the superintendent was stunned, and received a severe cut over the eye with several contused wounds; bricks in which the boiler had been imbedded were carried to a long distance off but the most serious consequence of the accident were the injuries sustained by a man named **Jenkins** and two others. **Jenkins** was seated on the brick wall at the time of the occurrence, and was hurled head downwards into the pen, receiving at the same time a perfect flood of the boiling water over his back and sides.

The two other men were also much injured, and it was considered necessary that the three sufferers should be sent to the Yass hospital for medical treatment, a distance of sixty miles, as it was alleged that no medical man could be procured nearer at hand. We are informed that the stoker had kept up a large fire in the furnace from the time the men went to dinner until the accident happened and had neglected to pump into the boiler a sufficient quantity of water. The three sufferers are now in the hospital, but we believe that the injuries they have received are not likely to prove fatal.

Jenkins was some time since the driver of the mail between Yass and Binalong and resided with his wife at the latter place. Whilst absent from home and employed in catching a horse, he received a most severe kick from the animal, which although it broke no bone caused a frightful flesh wound. During the time he was laid up news reached him from Binalong that his wife had been burnt to death **while in a state of intoxication**. A correspondent supplies us with the following: It was an eighteen foot boiler; there were thirteen men near it at the time of the accident and only two escaped without receiving some injury, more or less severe. The top of the boiler was blown into two pieces and carried one hundred feet off; one of the pieces was driven edgewise into the ground and bounded out again. It was built into

brick was on a stone foundation, not one brick remained on the top of another nor yet one stone. None of the sheep were injured. The men who were thrown into the soaking-pen were dragged out quickly with the exception of one who was not at first observed. He was, however, rescued just in time to save his life. He had been struck on the head, stunned, and immediately sank. *Yass Courier.*



*The accident proved to be **fatal** with David Jenkins date of death listed as 28 November 1864 at Yass.*

Family of Mary Ann Flynn and David Jenkins (5 children)

In 1864, after 10 years of marriage, both Mary Ann and David Jenkins were to both perish within 6 months of each other, leaving 5 children as orphans.

- On 24 May 1864, **Mary Ann Jenkins** aged 27 years, was found **burnt to death** at her home in Binalong after her clothes had caught alight at the fireplace
- On 28 Nov 1864, **David Jenkins** aged 38 years, died after the explosion of a boiler on the property 'Cumbamurra' (between Harden & Binalong). The water was used for the washing of sheep, this process separating grease and grit from the wool.

Both accidents and the fate of the 5 orphaned children are explained more fully below!

<u>Child 1 – Sarah Jenkins</u>	<u>Child 2 – Margaret Mary Jenkins</u>	<u>Child 3 – Elizabeth Jane 'Lillie' Jenkins</u>
<p>Born: 24 December 1855 'Cumbamurra' (between Harden & Binalong) Married: James O'Meley - 14 May 1874 at Yass Family: 12 children Died: 4 Sept 1934 West Wyalong</p>	<p>Born: 23 September 1857 in Victoria Married: Samuel McEwan – 12 January 1874 at Yass Family: 10 children Died: 29 Aug 1925 Dutton Park, Qld</p>	<p>Born: 13 December 1860 'Cocketegong' near Jerilderie, NSW</p>
		<p><i>(Family legend is that 'Lillie' Jenkins entered a convent; her family never again saw, heard from or of her. Her adoptive mother Sarah Evans left the Catholic Church, declaring its laws were inhumane! - (Page 196 'Kissin Cousins')</i></p> <p style="text-align: center;"><u>No Photo</u></p> <p><i>Reared by: Sarah Flynn & James Evans (Aunt & Uncle)</i></p>

Child 4 – John Jenkins

Born: c1861

Married: Margaret Mary O'Connell – 26 August 1890

Family: 7 children

Died: 15 Nov 1921 – Buried: Charters Towers, Qld

No Photo

Child 5 – Mathew Jenkins

Born: 13 May 1863 Binalong, NSW

Married: Ada Violet Hardy – 1899 Goodooga, NSW (near Qld border)

Family: 2 children

Died: 24 Dec 1942 Portland, NSW

No Photo

Reared by: Sarah Flynn & James Evans (Aunt & Uncle)

2. Sarah Flynn

Sarah Flynn and James Evans

An extract from 'Kissin Cousins' by Marjorie Kendall of 'Kendall Dale' Milton (near Ulladulla), first published in 1989.

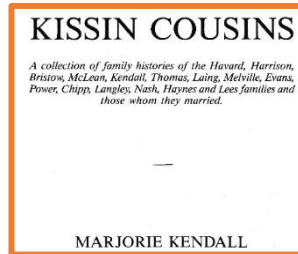

On 28 Nov 1859, **James Evans** married shepherdess, **Sarah Flynn** at St Augustine's, Yass. She was living with her father, **Matthew Flynn** (shepherd), and mother, at '**Cumbamurra**', (*property between Murrumburrah and Binalong*) where James Evans was a workman.

Sarah was **childless for the first ten years of her marriage**. When her sister Mary Ann Jenkins died 24 May 1864, **leaving five children**, Sarah and James Evans took the baby, **Matthew Jenkins**, and four year old **Elizabeth (Lillie) Jenkins** and brought them up as their own. James and Sarah were itinerant workers on pastoral leases and outback stations. James drove one horse-drawn wagon and Sarah, smoking her clay pipe, drove the other, loaded with children, chickens, cuttings from the fig tree, books and household goods. They were avid readers, Lord Byron being Sarah's favourite poet.



July 25 1953, Marjorie and Ken Kendall and their two daughters, Alita and Lea at Lea's christening. (Rev'd Feltham forgot to enter the Baptism in the Baptismal Register of Saint Peter and Saint Paul, Milton). Alita Lea are related by blood, marriage or adoption, closely or remotely to every family member whose name is in this book.

JAMES EVANS 1813–1899 and SARAH FLYNN 1840–1902

Family legend says full bearded, six feet four inches tall, spinner of yarns and teller of tales, James Evans was a seaman who came, with his brother, to the colony in 1837. Their parents were Thomas Evans, blacksmith, and Anne Calligan/Kelly, of Kingston, Dublin, Ireland. The legend continues that the brother took up a selection on the Lachlan and fathered eleven sons.

Their first child, **Frances Louise Evans (Fanny)** was born in 1869.

They were working as shepherds at “Red Bank”, an outstation on James Sloan’s station “North Logan”, when their son, **John Thomas Evans (Jack)** was born April 29, 1871. *(There exists today a property ‘Redbank’, near Murrumburrah which is near the property ‘Cumbamura’) – (The property ‘North Logan’ was located near the township of Cowra).*

James Sloan sent some of his finest wool to a Sydney mill to be woven into a plaid shawl for his employee’s long-awaited son. The shawl was used for all Sarah’s children, and then for John Thomas Evans’s own family. Fifty years later Clara Evans used it when making a hooked rug.

Their third child, **Sarah Evans** was born 1873.

Footnotes - remain as a matter of interest - (lettering codes have been removed from above text)

a) James Evans, Cert of death, 57 years in NSW, 5 years in Victoria.

aa) All my life I have listened to the family legends told by my mother, her sisters and my grandparents.

b) James Evans Cert of death. According to Marriage Register of St Augustine’s, Yass, his mother was Anne Kelly, and he was born in Hereford, England. Cert of Birth of youngest child, Harriet, James was born in Ireland.

c) A 60,000-acre lease held by James Manning, roughly from Jugiong Creek on the south, Cunningham Creek on the west. He sold the lease to SK Salting circa 1853. The name was then “Cumbramura”. It is in the Demondrille Shire, County of Harden.

d) The witnesses to the marriage were John and Sarah, son and daughter of Owen Hilly, publican of the “Squatter’s Home”, in Dutton Street, Yass.

e) Register of Deaths in District of Binalong, viewed Burrowa Court House, May 1986. Mary Ann Jenkins, accidental death when her clothes caught fire. Buried “Mylora”, near Binalong. AO NSW Reel 191 4/6614 May 24, 1864, Accidental Burning. Coroner J Patterson, JP at Binalong.

f) Family legend is that Lillie Jenkins entered a convent; her family never again saw, heard from or of her. Sarah Evans left the Catholic Church, declaring its laws were inhumane.

ff) Sarah planted a fig tree wherever they lived (carrying the cuttings with her), her daughter-in-law did the same. When Clara Evans entered a nursing home, she gave a cutting to her grand-daughter, Marjorie. The tree flourishes in “Kendall Dale” orchard. James and Sarah’s granddaughter, Lily May Evans, read their books as a child.

g) Cowra Land District, County of Bathurst, Parish of Glen Logan.

gg) Cert of Birth, Elizabeth Harriet Evans, father’s occupation, miner.

h) Dept of Education Archives.

JAMES EVANS 1813–1899 and SARAH FLYNN 1840–1902 (continued)

James Evans (Jim) 1876–1922 was born at Castlereagh, where Matthew and Lillie Jenkins, and Frances and John Evans attended school. Matt Jenkins and Jack Evans (who were cousins) were strikingly alike in facial features; Jack was tall and lean; Matt was a jockey.

James caught “gold fever” and went gold mining at Mullamuddy, near Mudgee. Here **Elizabeth Harriet Evans** (June 15, 1879 – Oct 27, 1912) was born and the older children attended the Provisional School. By 1884 they were at Half Way Creek, where the children, from fifteen year old Fanny to five year old Harriet, were taught in a “*house to house school*”.

Cudgegong was a change-over station on the Sydney to Mudgee Road for Cobb and Co. Their second child, Jack, remembered attending school there.

The two sons, Jack and Jim Evans, lived with and supported their parents (and sisters until they married), turning their hands to shearing, droving, fencing and bush carpentry. The family moved to **McLean’s “Crown Station” near Capertee** where Jack share-farmed at “**Fairy Meadow**” with one of the McLean boys. Drought struck early in 1899; there was no feed on “Fairy Meadow”. Jack Evans and his cousin, **Matthew Bellamy (Matt)**, both fine horsemen and crack rifle shots, contracted to drive a mob of Kidman’s cattle to the Diamantina River in Queensland. After a leisurely round trip of nine months, they returned home. They parted company at Bourke and Jack, feeling pleased with himself, returned to “Fairy Meadow”. They had not lost a beast, the camps had been convivial, Jack’s concertina and dry wit were appreciated round the campfire, there was money in his pocket.

John Thomas Evans found that he had a daughter, **Lily May**, born October 7, 1899.

He was in time to help make the coffin for his eighty-six year old father, **James Evans Snr**, who died October 13, 1899. The burial service, in the Church of England cemetery at Glen Alice, was conducted by the school master, HP Beaumont.

John Thomas Evans and sixteen year old **Clara Ann Power** were married, October 26, 1899, at Rylstone by Reverend John Joy Thorpe.

Sarah Evans welcomed her plump, energetic, practical daughter-in-law.

Clara Evans went home to her parents at ‘Airly’ for the birth of their second child, **Aileen Clare**, on Oct 14, 1900. The McLean family took a benevolent interest in Johnny’ and his new family. They asked permission to name the baby. Mrs McLean had her coachman take her to call on the mother and baby and left the traditional sovereign in the babe’s hand.

In 1902 John Thomas Evans, his wife, Clara, their two daughters, Lily and Aileen, and his mother, Sarah, moved to Razor Back, near Sofala, where Jack had the promise of a job as overseer on an out-station belonging to the **Corliss Family**. He was to receive one pound a week, a sheep per week (to kill for mutton), a ration of flour, sugar and tea, with the right to milk seven cows.

Sarah took ill. Jack rode to Sofala to get Dr Webb, who would not attend unless his fee (one pound) was paid. An old droving mate lent Jack the pound against his first wages. The doctor brought his grown-up daughter for the ride; the flighty horse kicked the sulky to pieces, Jack took Miss Webb pillion behind him, while Dr Webb rode the flighty horse.

Sarah Evans (nee Flynn) died the next day Jan 9, 1902, and was buried by Rev Hugh Kelly in the Church of England cemetery at Running Stream. The neighbouring women, who came to lay her out, wanted to cut off her long, brown, luxuriant hair (as a keepsake for the family).

Family of Sarah and James Evans

Child 1 – Frances Mary Evans

Born: 1869 Mudgee, NSW)

Married: Arthur Ernest Evens – 1894 Mudgee, NSW

Family: 3 children

Died: 17 March 1953 Windeyer, NSW



Child 2 – John Thomas Evans

Born: 29 Apr 1871 Cowra, NSW)

Married: Clara Ann Power – 26 Oct 1899 Rylstone, NSW

Family: 6 children

Died: 11 July 1954 Lithgow, NSW



John and Clara Evans and their children in the Capertee Valley. Photograph by Mr Kuhnert (L.L. to R) Lily May, with her hand on her father's knee, Aileen Clare and Olive on either side of their mother, Linda, in front.

Child 3 – Sarah Ann Evans

Born: c1873 (probably birth not registered)

Married: Donald McDonald – 28 October 1889 Rylstone, NSW

Family: 5 children

Died: 1931 Windeyer, NSW



Sarah Evans.

Family of Sarah and James Evans

Child 4 – James Evans

Born: 1876 Coonabarabran, NSW)

Married: Caroline Britton – 1907 Rylstone, NSW
(Caroline later married Edward Dickerson, whose real name was Steptoe. He had 'jumped ship' at the turn of the century!)

Family: 3 children

Died: 8 Oct 1924 Kandos, NSW

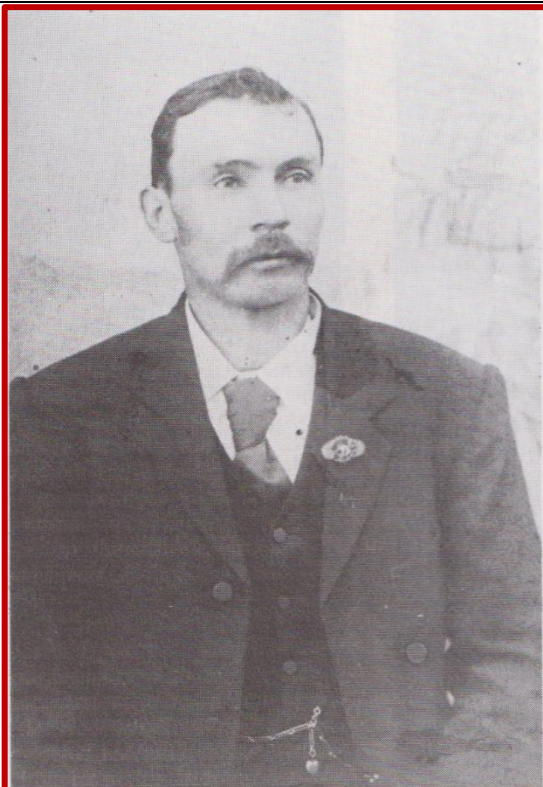

James Evans.

Child 5 – Elizabeth Harriet Evans

Born: 15 Jun 1879 Windeyer, NSW)

Married: Thomas Sidney Feltham – 1897 Rylstone, NSW

Family: 8 children

Died: 27 Oct 1912 Glenbrook (Blue Mountains), NSW



Elizabeth Harriet Evans.

3. Harriet Elizabeth Flynn

Story is just a brief glimpse and a “work in progress”!

Harriet Elizabeth Flynn was born on 25 March 1844 at ‘Honey Creek’, probably near Gunning or Binalong (location unclear). When she was baptised later that year, her parents Matthew Flynn and Elizabeth Smith / Leary were living on Cunningham Creek in the Harden / Jugiong locality.

On 2 February 1864, Harriet Flynn married **Edward Robert Bellamy** at the RC Church, Binalong.

Edward Bellamy was born on 26 December 1839 at Ballarat, Victoria, the eldest son of Samuel Bellamy and Johanna (nee Hayes). Samuel Bellamy was a London immigrant, while Johanna Hayes had migrated from Limerick, Ireland. Samuel and Johanna were married in Melbourne, Victoria on 25 February 1839.

Harriet Elizabeth and Edward Robert Bellamy had quite a large family of 11 children:

<u>Name</u>	<u>Date of Birth</u>	<u>Born at:</u>	<u>Married:</u>
<i>Samuel John Bellamy</i>	<i>27 Nov 1864</i>	<i>‘Tyagong’ between Grenfell & Young</i>	<i>Henrietta Louisa Coleman</i>
<i>Matthew Bellamy</i>	<i>1865</i>	<i>(Registered at Young)</i>	
<i>Edward Bellamy</i>	<i>1867</i>	<i>‘Blind Creek’ Murrumburrah</i>	<i>Mary Jane Mitchell</i>
<i>George Bellamy</i>	<i>21 Apr 1868</i>	<i>Registered at Young</i>	<i>Elizabeth Ann Cartwright</i>
<i>Henry Bellamy</i>	<i>26 Feb 1872</i>	<i>Registered at Young</i>	
<i>Sarah Elizabeth Bellamy</i>	<i>14 Oct 1874</i>	<i>Registered at Young</i>	<i>Daniel Robert Flanagan</i>
<i>Levina Bellamy</i>	<i>3 Oct 1876</i>	<i>Registered at Grenfell</i>	<i>Patrick Curry</i>
<i>Mary Bellamy</i>	<i>22 Sept 1880</i>	<i>Grenfell ‘Seven Mile Creek’</i>	<i>Sydney John Hughes</i>
<i>John Joseph Bellamy</i>	<i>22 Sept 1880</i>	<i>Grenfell ‘Seven Mile Creek’</i>	<i>Louisa Jane Hughes</i>
<i>Johanna Bellamy</i>	<i>15 July 1882</i>	<i>Registered at Grenfell</i>	<i>m 1920</i> <i>Wallace William Mason</i>
<i>Harriet Ellen Bellamy</i>	<i>31 Mar 1888</i>	<i>Registered at Grenfell</i>	<i>m 1913 died 1914</i> <i>Wallace William Mason</i>

Baptismal extracts from St Mary’s Catholic Church, Young relating to the Bellamy Family

St Mary’s Catholic Church, Young

Baptisms 1862 – 1908

(Young & District Family History Group)

<u>Born</u>	<u>Baptised</u>	<u>Name</u>	<u>Parents</u>	<u>Abode</u>	<u>Sponsor</u>	<u>Priest</u>
27/11/1864	07/05/1865	Samuel John	Bellamy Edward Flynn Harriette	Tyagong	Kelly Margaret	O’Neill
3/10/1876	22/10/1876	Levinia	Bellamy Edward Flinn Harriett	near Grenfell	Bellamy Levina	E McCarthy
22/9/1880	31/10/1880	Mary	Bellamy Edward Flynn Harriet	Seven Mile Creek, Grenfell	Rumble Garner Kelly Margaret	JJ Gaffey
22/9/1880	31/10/1880	John Joseph <i>(twins)</i>	Bellamy Edward Flynn Harriet	Seven Mile Creek, Grenfell	Rumble Garner Kelly Margaret	JJ Gaffey <i>(to Page 100)</i>

Further insight into the Bellamy Family

Father Max Barrett in his book “Galong Cemetery” provides some additional insights into the Bellamy Family:

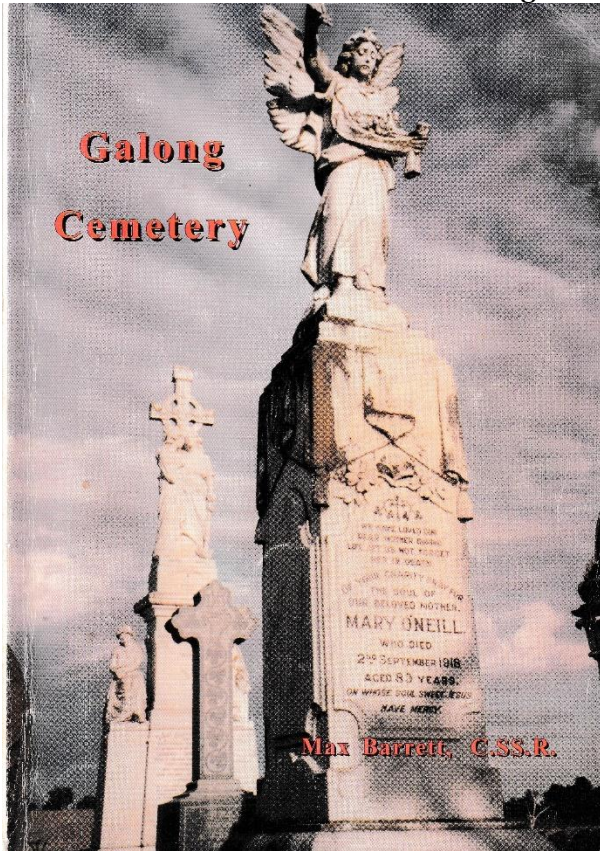

Galong Cemetery – Max Barrett C.S.S.R

Bellamy and Rumble

Two Samuel Bellamys, father and five-year-old son, are buried in Galong Cemetery. The senior Bellamy's birth date was somewhere between 1805 and 1809.

London-born, he was at times given the Christian name of John; and one of his descendants avers *{asserts}* that his surname was Bentley Bellamy.

Sam married Johanna Hayes in Melbourne on 25 February 1838. Their first child, Edward, saw the light of day in December of the following year. Interestingly, a book presented “to Edward Bellamy, Mount Sturgeon Station, Victoria (*near the Grampian Ranges*) ... on his 13th birthday (26 December 1852)” was long preserved in the Bellamy family.

Soon after 1852, the Bellamys moved north to New South Wales and settled at Binalong where a second boy Samuel Jnr completed the family on 31 May 1856. In between Edward and baby Samuel were six girls: Margaret (1840); Isabella (1842); Mary Elizabeth (1844); Johanna (1846); Teresa Matilda (1850) and Lavinia (1852).

The father of these Bellamys, Samuel Bellamy, was described in documents as a carpenter, a teamster and as a farmer in Binalong. He died in 1861, only three months after his five-year-old son, also Samuel Bellamy. Sam's wife, Johanna (nee Hayes) came from Limerick Ireland. She was much younger (nine years? fourteen years?) than her husband. Twenty one months after Samuel's death, the widow Johanna married William Rumble. She spent at least some of her latter years at Grenfell.

The **Rumbles**, from Cambridgeshire, migrated to Australia in 1854. Shortly after their ship left England, cholera broke out. The 10-year-old in the Rumble family caught the disease and was nursed back to health by his mother's devoted care. But Mrs Rumble had become infected, and she died. Her husband was left to cope alone with six children. On arrival in the colony, he established a pack horse route from Sydney to Tumut, via Goulburn. It was nine years later that William Rumble married widow Johanna Bellamy.

And, within two months, William's son John married Johanna's daughter Isabella.

There was obviously a strong Bellamy-Rumble compatibility. In 1875 yet another Bellamy (Lavinia) married yet another Rumble (Garner).

According to a newspaper tribute following her death in 1908, Isabella Rumble had been born in Gawler, South Australia. She died at 'Water Vale', Barwang (*between Harden and Young*). Nine of her thirteen children survived her.

The Bellamy family became firmly established in the Binalong district.

In addition to the nuptials already mentioned, two Bellamy sisters Margaret and Mary Elizabeth, wedded two Kelly's brothers' William and Robert. **Edward Bellamy**, first born of Sam and Johanna Bellamy, married **Harriett Elizabeth Flynn**.

Bellamy – Land Acquisition

The section of [Douglas Parish Map \[County of Harden\]](#) below shows the Bellamy, Kelly and Rumble families living in the same area. These properties were apparently in the Barwang / Black Range area between Young, Boorowa and Harden-Murrumburrah.

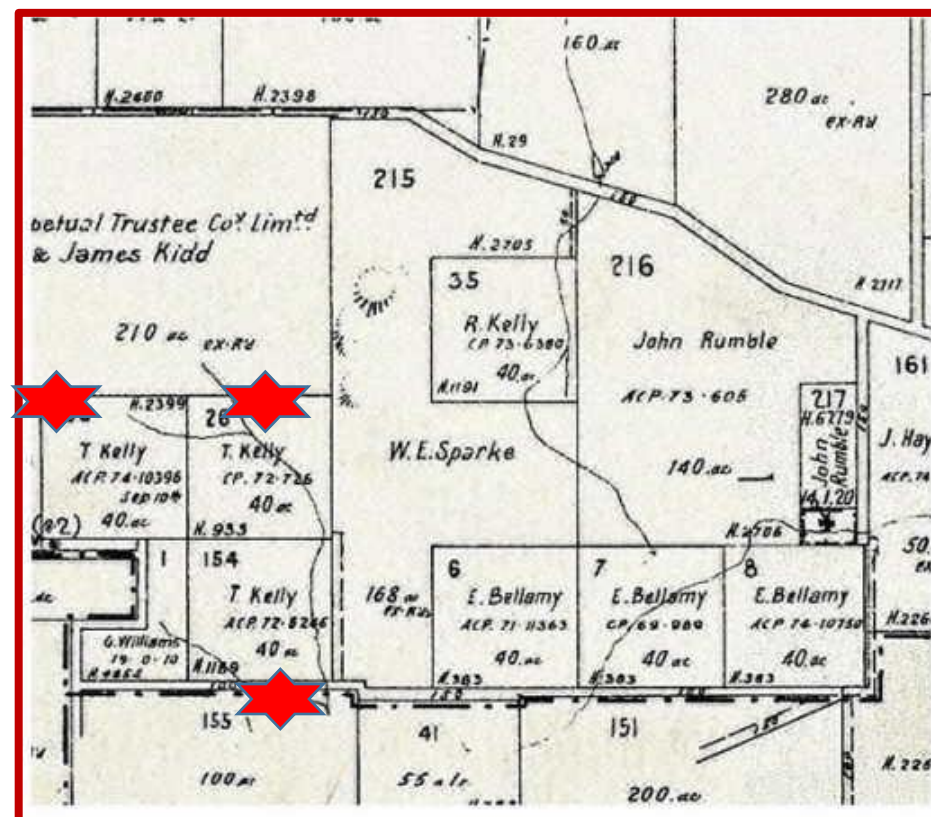
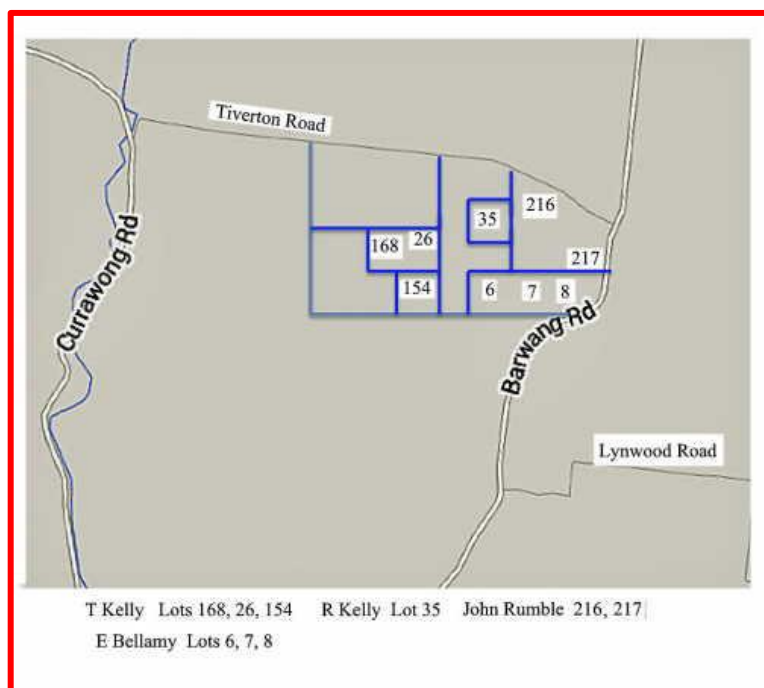

Background to the Maps

In 1825 Royal Instructions were issued to Governor Brisbane ordering a general survey of the colony of New South Wales and its division into counties and parishes. County and parish maps have been used for over 150 years to record Crown land dealings.

Two sets of county, parish and town/village maps were created and maintained by the Department of Lands and its predecessors. One set of maps, for a particular area, was kept at the Local or District offices and a duplicate set for the whole State was kept in the Head Office of the Department.

Types of Maps

County maps

There are **141 counties** in New South Wales. Each county has an area of about 40 square miles. The maps show the division of counties into parishes, major physical features and large portions with their numbers. County maps have a scale of 4 miles to an inch. In the map above, the **County** was **Harden**.

Parish maps

The 141 counties are divided into **7,459 parishes**. Parish areas range from fifteen to twenty five square miles. Parish maps are produced for the Eastern and Central divisions of New South Wales. They have not been compiled for the Western division, or for 'private' towns subdivided out of privately owned land. Parish maps are at a scale of 4 inches to a mile. In the map above, the **Parish** was **Douglas**.

Edward Bellamy and Harriet Bellamy (nee Flynn)

Edward Bellamy and Harriet Bellamy (daughter of Elizabeth Smith) moved to Grenfell district around 1875/1876 and took up land just near the 7 mile south of Grenfell. Edward and Harriet's property was called 'Trevoka' – Parish of Coba – County of Montegale.



Bellamy
Property
near the 7
Mile,
Grenfell

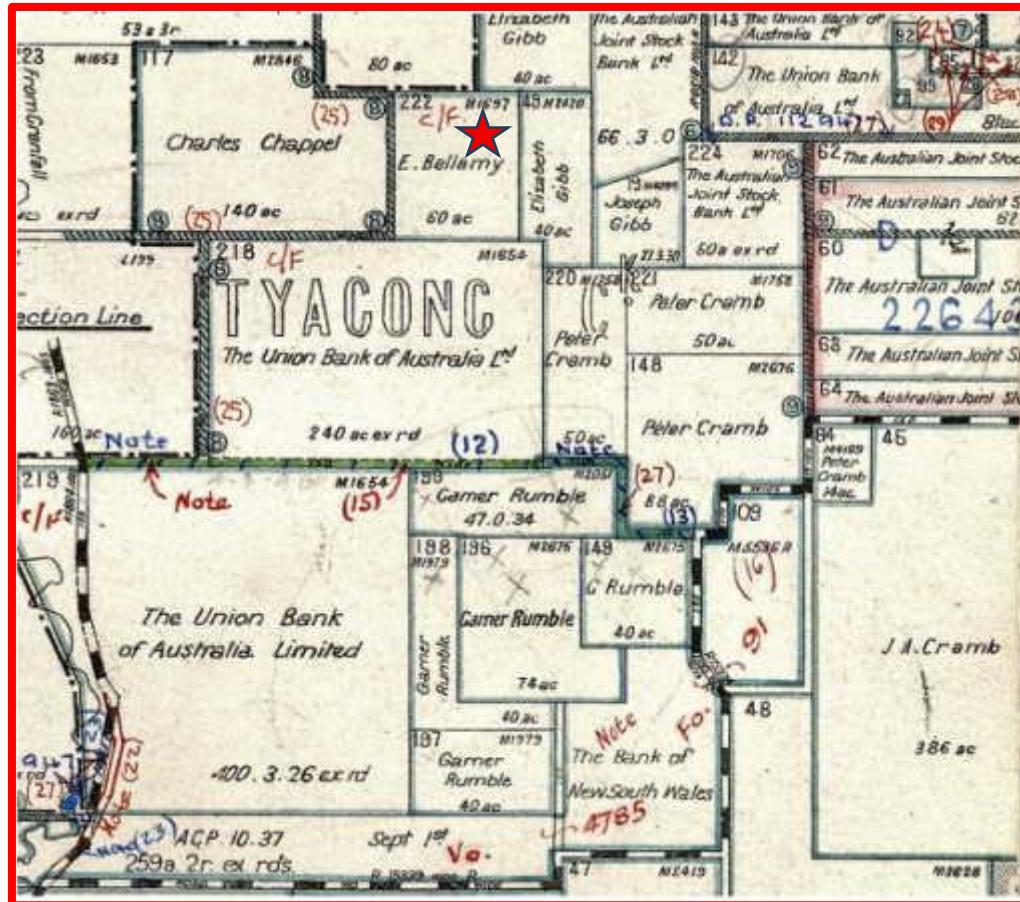

7 Mile, Grenfell

The Seven Mile at Grenfell where Elizabeth Flynn (Flynn) was residing with her daughter Harriet and son-in-law Edward Bellamy had a most interesting history.

SEVEN MILE RUSH/WEDDIN

In 1867 Thomas Holton was working in Prince Alfred Gully, seven miles (11 km) from Grenfell. There were several leads in this find, all of which met at the spot known as Seven Mile. At least 5000 men were working on alluvial claims. There were numerous hotels and stores set up, as well as a blacksmith's shop.

The Peep of Day was the most successful claim, with the two owners taking out £550 each for three months work. H J Slee, who later became Inspector of Mines, had a claim on which a large nugget weighing 7½ oz (213 g) was found.

After the gold petered out, many men stayed on and fossicked around, getting enough money to live, but not much more.

A school opened at Seven Mile in 1876 in a building donated by Mr John Simpson, who was involved with getting the school established. It started with 40 pupils. The school closed in 1937. Mr Simpson was also involved with the local store, and became Postmaster in 1884. His mother-in-law Mrs McKenzie opened the Weddin Hall in 1890.

Seven Mile is now known as Weddin.

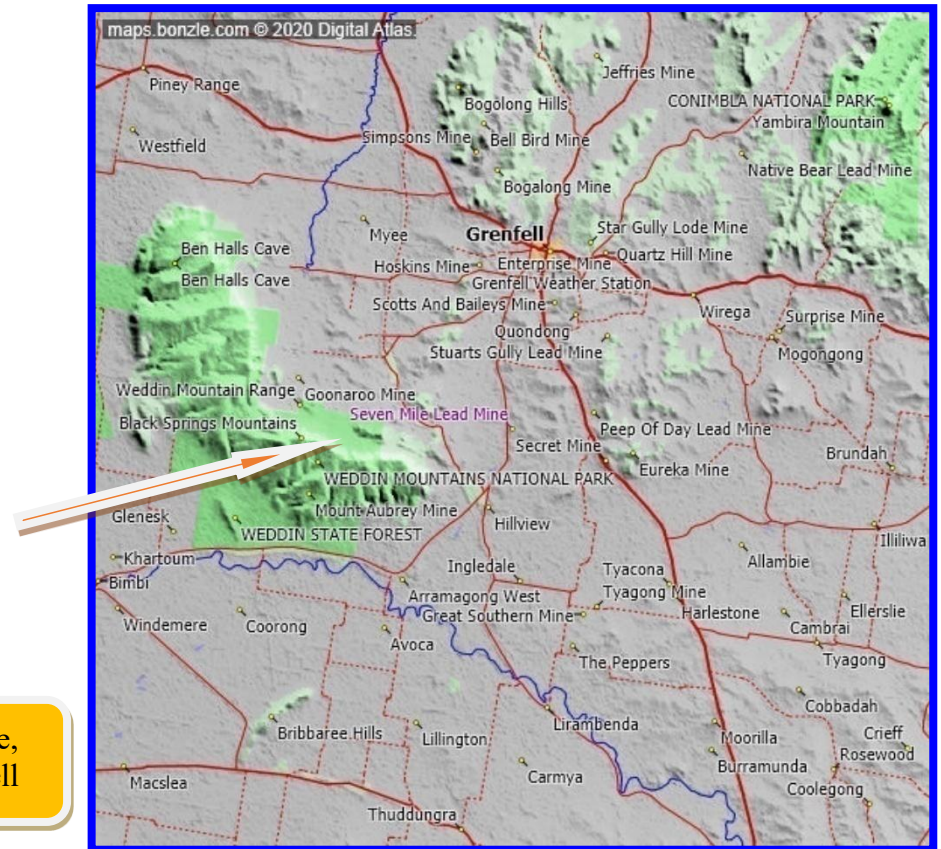





7 Mile Mine,
near Grenfell

*The **Bellamy** family, living on the goldfields at the 7 Mile had quite a full household.*

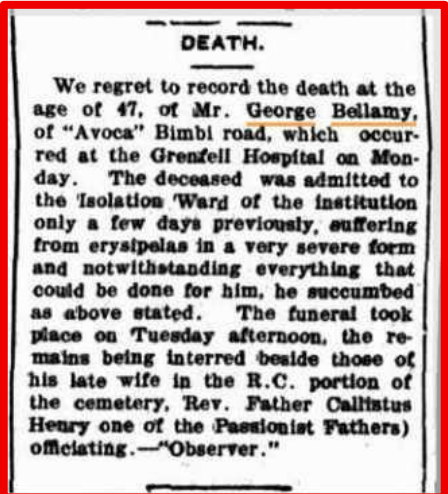

*Elizabeth Flynn's daughter **Harriet Bellamy** was to give birth to her seventh of eleventh children in 1880 at the time of the death of her mother, and our convict ancestor,*

❖ Elizabeth Flynn [earlier Leary nee Smith].

Family of Harriet Flynn and Edward Bellamy (11 children)

<p align="center"><i>Samuel John Forbes Bellamy</i> <i>m Henrietta Coleman</i></p>	<p align="center"><i>Matthew Bellamy</i></p>	<p align="center"><i>Edward Bellamy</i> <i>m Mary Jane Mitchell</i></p>
		
<p align="center"><i>George Bellamy</i> <i>m Elizabeth Ann Cartwright</i></p>	<p align="center"><i>Henry Bellamy</i> <i>m Hilda Eloise Doubleday</i></p>	<p align="center"><i>Sarah Elizabeth Bellamy</i> <i>m Daniel Richard Flanagan</i></p>
		

Family of Harriet Flynn and Edward Bellamy (11 children) – continued

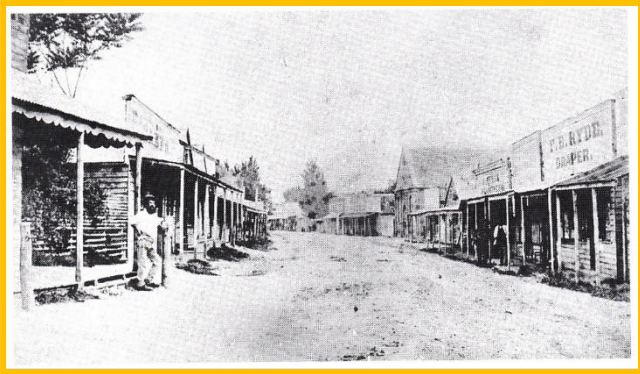
<p align="center"><i>Lavinia Bellamy</i> <i>m Patrick Curry</i></p>	<p align="center"><i>Mary Bellamy</i> <i>m Sydney John Hughes</i></p>	<p align="center"><i>John Joseph Bellamy</i> <i>m Louisa Jane Hughes</i></p>
		
<p align="center"><i>Joanna Bellamy</i> <i>m Wallace William Mason - 1920</i></p>	<p align="center"><i>Harriet Ellen Bellamy</i> <i>m Wallace William Mason - 1913</i></p>	
		 <p align="center"><i>George Street, Grenfell 1881</i></p>

John Malone's Personal Background Story with Marjorie Kendall and her book "Kissin Cousins"

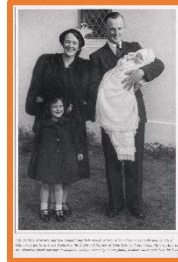
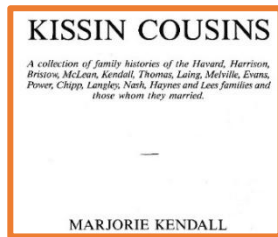
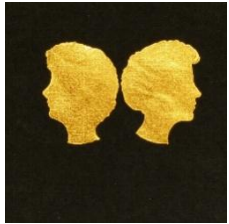

The complex nature of **Sarah Flynn's Convict Ancestors** was not fully understood when I received the accompanying letter from **Marjorie Kendall** dated 17 June 1984.

Marjorie Kendall was researching the Evans family and I had an interest in a "different" **Evans family** at Boorowa.

- **Henry Evans** (a convict) had married my ancestor **Johanna Butler**
- After Henry's death his widow **Johanna (nee Butler)** was to marry my ancestor **Joseph Barton**.

I had done quite an extensive amount of research on another convict ancestor **Elizabeth Smith** who married **John Leary** and they had a daughter **Catherine Leary**.

Catherine Leary had a de-facto relationship with **John O'Keefe (John Keeffe)** and they produced a large family of 7 children which included my Great Grandfather John Keefe (1852-1926).

The de-facto relationship between **Catherine Leary** and **John O'Keefe (John Keeffe)** was **always puzzling** – but as research continued the puzzle eventually unravelled.

Kendall Dale,
Milton. 2538.
17.6.1984

Mr Maloney,
47 Bapaume St.,
Cootamundra 2590.

Dear Mr Maloney,

I see by the Genealogical Research Directory that you are interested in the Evans of Boorawa. My interest is

2 Sons of Thomas Evans & Ann Kelly of Hereford England came to Australia some time before 1859. My line was

James Evans born 1812 Hereford died 1896 Glenn Alice married 28.11.1859 Sarah Flynn

They had 5 children

BUT

all we know of the other brother was that he took up a selection on the darling river & had eleven sons.

Is your Boorawa Evans that line?

Yours sincerely,
Marjorie Kendall
Mrs. M. Kendall.

Ray Sullivan Correspondence

*Contact with **Ray Sullivan** of French's Forest really opened up my family research which finally led to a visit to Cootamundra where he was to unfold his marvellous collection of research material. In the accompanying translated letter dated 27 Sept 1988 he states we had begun correspondence in 1985.*

Ray Sullivan

41 Paxton St

French's Forest, NSW 2086

27-9-1988

Dear John,

*I don't know if you realise it but you and I **corresponded briefly in 1985**. You wrote to me in August that year regarding Catherine Leary and your ancestor John O'Keefe. At that time, I wrote back to you that there seemed to me that our ancestors had no common ground. How things can change.*

Based on circumstantial evidence and an acceptance of people breaking the accepted moral standard of that period it looks as though we have a common ancestral background.

Enclosed are copies of documents I have obtained in my research of the Leary-Sullivan connection.

Catherine Leary was born in N.S.W. on the 4th January 1833 and on the 11th April 1847 at the age of 14 years 3 months she married a former convict named Jeremiah Sullivan who was aged 30 years. They had two children Mary Ann Sullivan born 27/9/1847 and Daniel Sullivan born 3/1/1850.

If the circumstantial evidence is now to be believed something must have happened between Jeremiah and Catherine because she has formed a liaison of sorts back with John O'Keefe in her maiden name.

Between 1853 and 1865 Catherine Leary (Sullivan?) and John O'Keefe had seven children.

Catherine Leary (née Sullivan) died in the public hospital at Yass on the 4th May 1871. She was 38 years of age. I wonder why she was deserted by her children, her legal husband and her de-facto when she died at Yass. As you will see from her death certificate it was a hospital employee, not a family member, who was the informant of her death. The death certificate provides very little information and even gives her maiden surname as Flynn. Actually, it was this reference to Flynn that led me to her mother's second marriage.

So far, I have been unable to find out when Elizabeth (Smith, Leary, Flynn?) died and where. I wonder if she is buried in one of those little cemeteries around Binalong, Booka Dam or Boorowa. (By the way are Boorowa and Burrowa the same place spelt differently?)

During some of my early research I came across another John Leary and Catherine Leary (née Jones or Johnson) who were married in 1825. They also had a daughter named Catherine who was born on 16/4/1826. I did some further research (I can't find my records of it) but as it doesn't appear to relate to my Learys I discontinued my investigation.

I am still trying to find out when and where Elizabeth died. She may even have married a third time following the death of Matthew Flynn. I also want to find out if Elizabeth and Matthew had any children.

Anyhow John I hope the enclosed information will assist you and I look forward to hearing from you again.

Best wishes,

Ray Sullivan

John Malone's Personal Background Story with Marjorie Kendall and her book "Kissin Cousins" (continued)

As it turned out, I believe that Ray Sullivan and I probably played a major part in the piecing together of the intertwined lives of:

CONVICT PIONEERS

ELIZABETH SMITH (c1803-1880) - JOHN LEARY (1795-1854) – MATTHEW FLYNN (1802 -1866)

Convicts Elizabeth Smith and John Leary married and baptised their daughter Catherine Leary on 15 January 1833 in Sydney.

Catherine Leary was my ancestor and I had done a considerable amount of research regarding her de-facto relationship with John O'Keefe [John Keefe] and their large family of 7 children.

*Until contact was made with Ray Sullivan, I was **not aware** of Catherine's previous marriage to convict and confectioner Jeremiah Sullivan on 6 April 1847 at the RC Church at Campbelltown and the birth of two children:*

- *Mary Ann Sullivan born 27 September 1847 at Menangle, NSW*
- *Daniel Sullivan born 3 January 1850 at Menangle, NSW*

*Likewise, at this early stage in his research, Ray Sullivan was also **not aware** of Catherine Leary (Sullivan) separation from her husband Jeremiah Sullivan and her inland expedition to the Boorowa / Frogmore area where the relationship with John O'Keefe was to furnish a further 7 children.*

The fact that Catherine Leary was never to marry John O'Keefe became clear when it was realised that Catherine was still legally married to Jeremiah Sullivan.

*The full story of our convict ancestors below appears as a **separate story**:*

CONVICT PIONEERS

ELIZABETH SMITH (c1803-1880) - JOHN LEARY (1795-1854) – MATTHEW FLYNN (1802 -1866)

Marjorie Kendall and her book "Kissin Cousins" , was published in 1989 and contained much of the early research material of Ray Sullivan and John Malone.

The constant missing piece of information that finally tied all this information together was the missing death certificate of Elizabeth Flynn (formerly Elizabeth Leary [nee Smith]).

After a **28 year search** the death certificate was uncovered

Children of John O'Keefe and Catherine Leary (Sullivan)
(some children retained O'Keefe name, others chose Keefe)

John Keefe (b1852) m Charlotte Matilda Gorham



Patrick O'Keefe (1) (1856-1856)
died aged 4 months

William Keefe (b1858) m Charlotte Matilda Horton

Johanna O'Keefe (b1859) married Patrick Corkery



Michael O'Keefe (b1861) married Harriet Roberts



Patrick O'Keefe (2) (b1864) m Eliza Jane Rolles
(nee Good)



James O'Keefe (1865 – 1885)
died aged 19 yrs – inflammation of the lungs

Family Group Sheet for John O'Keefe & Catherine Leary

Partner **John O'Keefe**

Birth: Abt. 1815 in Newcastle, Tipperary, Ireland
 Baptism: 15 Jul 1815 in Newcastle, Tipperary, Ireland; Diocese of Waterford
 Burial: 1879 in Boorowa, New South Wales, Australia
 Death: 02 May 1879 in Phils Creek, New South Wales, Australia
 Father: **William Keefe**
 Mother: **Margaret Keating**

Partner **Catherine Leary**

Birth: 30 Dec 1832 in Menangle, New South Wales, Australia
 Baptism: 15 Jan 1833 in Sydney, New South Wales, Australia; St Mary's Cathedral
 Death: 04 May 1871 in Yass, New South Wales, Australia; Yass Hospital
 Father: **John Leary**
 Mother: **Elizabeth Smith**

Children:

1 Name: **John Keefe**
 M Birth: 14 Feb 1852 in Frogmore, New South Wales, Australia; Frogs Hole
 ⚰ Baptism: 18 Feb 1853 ; Parish of Yass, County of Murray
 Marriage: 30 Jan 1878 in Boorowa, New South Wales, Australia; St John the Baptist Church
 Death: 30 Nov 1926 in Rye Park, New South Wales, Australia; "Klondyke"
 Burial: Rye Park, New South Wales, Australia
 Spouse: **Charlotte Matilda Gorham**

2 Name: **Patrick Keefe**
 M Birth: 22 Jun 1856 in Burrowa, New South Wales, Australia
 ⚰ Death: 08 Jul 1856 in Burrowa, New South Wales, Australia; died aged 4 months
 Burial: 10 Jul 1856 in Burrowa, New South Wales, Australia

3 Name: **William Keefe**
 M Birth: 26 Jun 1858 in Frogmore, New South Wales, Australia
 ⚰ Marriage: 29 Jul 1885 in Boorowa, New South Wales, Australia
 Death: 16 Apr 1924 in Liverpool, New South Wales, Australia; Liverpool Hospital
 Spouse: **Charlotte Matilda Horton**

4 Name: **Johanna O'Keefe**
 F Birth: 12 May 1859 in Gunnary Creek, New South Wales, Australia
 ⚰ Marriage: 05 Feb 1879 in Boorowa, New South Wales, Australia; St Patricks Church
 Death: 02 Nov 1927 in Boorowa, New South Wales, Australia; Boorowa District Hospital
 Spouse: **Patrick Thomas Corkery**

5 Name: **Michael Henry O'Keefe**
 M Birth: 08 Jun 1861 in Phils Creek, New South Wales, Australia
 ⚰ Baptism: 19 May 1879 in Boorowa, New South Wales, Australia; St Patrick's RC Church (aged 18 yrs)
 Marriage: 24 Jul 1885 in Boorowa, New South Wales, Australia
 Death: 21 Dec 1946 in Boorowa, New South Wales, Australia; District Hospital
 Spouse: **Harriet Roberts**

6 Name: **Patrick O'Keefe**
 M Birth: 20 Feb 1864 in Frogmore, New South Wales, Australia
 ⚰ Baptism: 19 May 1879 in Boorowa, New South Wales, Australia; St Patrick's RC Church (aged 16 yrs)
 Marriage: 05 Aug 1908 in Coonamble, New South Wales, Australia; Church of England Rectory
 Death: 19 Jul 1952 in Dubbo, New South Wales, Australia
 Burial: Dubbo, New South Wales, Australia
 Spouse: **Eliza Jane Good**

7 Name: **James O'Keefe**
 M Birth: Abt. 1865 in Phils Creek, New South Wales, Australia
 ⚰ Burial: 1885 in Boorowa, New South Wales, Australia
 Death: 08 Feb 1885 in Boorowa, New South Wales, Australia

Family Group Sheet for Mary Ann Flynn & David Jenkins

Husband **David Jenkins**
 Birth: 1826 in Belfast, Antrim, Northern Ireland
 Marriage: 22 Aug 1854 in Yass, New South Wales, Australia; St Augustine's RC Church
 Death: 28 Nov 1864 in Yass, New South Wales, Australia
 Father:
 Mother:

Wife **Mary Ann Flynn**
 Birth: 1837 in Goulburn, New South Wales, Australia
 Burial: 1864 in Binalong, New South Wales, Australia; Mylora Cemetery
 Death: 24 May 1864 in Binalong, New South Wales, Australia
 Father: **Matthew Flynn**
 Mother: **Elizabeth Smith**

Children:

- 1 Name: **Sarah Jenkins**
 F Birth: 24 Dec 1855 in Cumbamurra, New South Wales, Australia; 'Cumbamurra' property between Harden and Binalong
 ☞☞ Marriage: 14 May 1874 in Yass, New South Wales, Australia
 Death: 04 Sep 1934 in West Wyalong, New South Wales, Australia
 Spouse: **James O'Meley**
- 2 Name: **Margaret Mary Jenkins**
 F Birth: 23 Sep 1857 in Victoria, Australia
 ☞☞ Marriage: 12 Jan 1874 in Yass, New South Wales, Australia
 Death: 29 Aug 1925 in Dutton Park, Queensland, Australia
 Spouse: **Samuel McEwan**
- 3 Name: **Elizabeth Jane Jenkins**
 F Birth: 13 Dec 1860 in Jerilderie, New South Wales, Australia; 'Cocketgedong' near Jerilderie
 ☞☞
- 4 Name: **John Jenkins**
 M Birth: Abt. 1861
 ☞☞ Marriage: 26 Aug 1890
 Death: 15 Nov 1921 in Queensland, Australia
 Burial: Charters Towers, Queensland, Australia
 Spouse: **Margaret Mary O'Connell**
- 5 Name: **Mathew Jenkins**
 M Birth: 11 May 1863 in Binalong, New South Wales, Australia
 ☞☞ Marriage: 1899 in Goodooga, New South Wales, Australia
 Death: 1942 in Portland, New South Wales, Australia
 Spouse: **Ada Violet Hardy**

Family Group Sheet for Sarah Flynn & James Evans

Husband **James Evans**
 Birth: Abt. 1813 in Hereford, Herefordshire, England
 Marriage: 28 Nov 1859 in Yass, New South Wales, Australia; St Augustine's RC Church
 Death: 13 Oct 1899 in Glen Alice, New South Wales, Australia
 Burial: Glen Alice, New South Wales, Australia
 Father: **Thomas Evans**
 Mother: **Anne Calligan Kelly**

Wife **Sarah Flynn**
 Birth: 06 Dec 1840 in Lake George, New South Wales, Australia; Honey Flat
 Baptism: 04 Dec 1844 in Yass, New South Wales, Australia; St Augustine's RC Church
 Death: 09 Jan 1902 in Sofala, New South Wales, Australia
 Father: **Matthew Flynn**
 Mother: **Elizabeth Smith**

Children:

- 1 Name: **Frances Mary Evans**
 F Birth: 04 Jan 1869 in Mudgee, New South Wales, Australia; Registered at Binalong
 ☞☞ Marriage: 1894 in Mudgee, New South Wales, Australia
 Death: 17 Mar 1953 in Windeyer, New South Wales, Australia
 Burial: Windeyer, New South Wales, Australia; Mudgee General Cemetery
 Spouse: **Arthur Ernest Evens**
- 2 Name: **John Thomas Evans**
 M Birth: 29 Apr 1871 in Cowra, New South Wales, Australia; 'North Logan'
 ☞☞ Marriage: 26 Oct 1899 in Rylstone, New South Wales, Australia
 Death: 11 Jul 1954 in Lithgow, New South Wales, Australia
 Spouse: **Clara Ann Power**
- 3 Name: **Sarah Ann Evans**
 F Birth: Abt. 1873 ; Probably not registered
 ☞☞ Marriage: 28 Oct 1889 in Rylstone, New South Wales, Australia
 Death: 1931 in Windeyer, New South Wales, Australia
 Burial: Windeyer, New South Wales, Australia
 Spouse: **Donald McDonald**
- 4 Name: **James Evans**
 M Birth: 1876 in Coonabarabran, New South Wales, Australia
 ☞☞ Marriage: 1907 in Rylstone, New South Wales, Australia
 Death: 08 Oct 1924 in Kandos, New South Wales, Australia
 Spouse: **Caroline Britton**
- 5 Name: **Elizabeth Harriet Evans**
 F Birth: 15 Jun 1879 in Windeyer, New South Wales, Australia; Mullabuddy
 ☞☞ Marriage: 1897 in Rylstone, New South Wales, Australia
 Death: 27 Oct 1912 in Glenbrook, New South Wales, Australia; Registered Penrith
 Spouse: **Thomas Sidwell Feltham**

Family Group Sheet for Harriett Elizabeth Flynn & Edward Bellamy

Husband		Edward Robert Bellamy
	Birth:	26 Dec 1839 in Ballarat, Victoria, Australia
	Marriage:	02 Feb 1864 in Binalong, New South Wales, Australia; RC Church
	Death:	21 Jun 1918 in Grenfell, New South Wales, Australia; Residence at 'Kikiamah'
	Burial:	22 Jun 1918 in Grenfell, New South Wales, Australia
	Father:	Samuel Bellamy
	Mother:	Johanna Hayes
Wife		Harriett Elizabeth Flynn
	Birth:	25 Mar 1844 in Binalong, New South Wales, Australia; Honey Creek
	Baptism:	04 Dec 1844 in Yass, New South Wales, Australia; St Augustine's RC Church
	Death:	02 Jul 1923 in Grenfell, New South Wales, Australia
	Father:	Matthew Flynn
	Mother:	Elizabeth Smith
Children:		
1	Name:	Samuel John Forbes Bellamy
M	Birth:	27 Nov 1864 in Tyagong, New South Wales, Australia
☪	Baptism:	07 May 1865 in Tyagong, New South Wales, Australia
	Marriage:	26 Jan 1893 in Forbes, New South Wales, Australia; The Vicarage (Church of England)
	Death:	31 May 1928 in Grenfell, New South Wales, Australia; District Hospital
	Spouse:	Henrietta Louisa Coleman
2	Name:	Matthew Bellamy
M	Birth:	1865 ; Registered at Young
☪		
3	Name:	Edward Bellamy
M	Birth:	27 Jan 1866 in Murrumburrah, New South Wales, Australia; Blind Creek
☪	Marriage:	24 Sep 1894 in Grenfell, New South Wales, Australia
	Death:	08 Apr 1957 in West Wyalong, New South Wales, Australia
	Burial:	West Wyalong, New South Wales, Australia
	Spouse:	Mary Jane Mitchell
4	Name:	George Bellamy
M	Birth:	21 Apr 1868 in Murrumburrah, New South Wales, Australia; Registered at Young
☪	Death:	12 Feb 1917 in Grenfell, New South Wales, Australia
	Burial:	Grenfell, New South Wales, Australia
	Spouse:	Elizabeth Ann Cartwright
5	Name:	Henry Bellamy
M	Birth:	26 Feb 1872 in Murrumburrah, New South Wales, Australia; Registered at Young
☪	Marriage:	1911 in Grenfell, New South Wales, Australia
	Death:	21 Feb 1938 in Cowra, New South Wales, Australia
	Spouse:	Hilda Eloise Doubleday
6	Name:	Sarah Elizabeth Bellamy
F	Birth:	14 Oct 1874 in Murrumburrah, New South Wales, Australia; Registered at Young
☪	Marriage:	1898 in Grenfell, New South Wales, Australia
	Death:	24 Jun 1951 in Monteagle, New South Wales, Australia
	Spouse:	Daniel Richard Flanagan
7	Name:	Lavinia Bellamy
F	Birth:	05 Oct 1876 in Grenfell, New South Wales, Australia; Abode: near Grenfell
☪	Baptism:	22 Oct 1876 in Grenfell, New South Wales, Australia; Abode: near Grenfell
	Death:	01 May 1958
	Spouse:	Patrick Curry

8	Name:	Mary Bellamy
F	Birth:	22 Sep 1880 in Grenfell, New South Wales, Australia; Seven Mile Creek
☪	Baptism:	31 Oct 1880 in Grenfell, New South Wales, Australia; Seven Mile Creek
	Death:	1957 in Newtown, New South Wales, Australia
	Spouse:	Sydney John Hughes
9	Name:	John Joseph Bellamy
M	Birth:	22 Sep 1880 in Grenfell, New South Wales, Australia; Seven Mile Creek
☪	Baptism:	31 Oct 1880 in Grenfell, New South Wales, Australia; Seven Mile Creek
	Marriage:	1914 in Young, New South Wales, Australia
	Death:	28 Aug 1970 in Cootamundra, New South Wales, Australia
	Spouse:	Louisa Jane Hughes
10	Name:	Joanna Bellamy
F	Birth:	15 Jul 1882 in Grenfell, New South Wales, Australia; Registered at Grenfell
☪	Marriage:	1920 in Grenfell, New South Wales, Australia
	Death:	1966 in Wallsend, New South Wales, Australia
	Spouse:	Wallace William J Mason
11	Name:	Harriet Ellen Bellamy
F	Birth:	31 Mar 1888 in Grenfell, New South Wales, Australia; Registered at Grenfell
☪	Marriage:	1913 in Grenfell, New South Wales, Australia
	Death:	05 Mar 1914 in Grenfell, New South Wales, Australia
	Spouse:	Wallace William J Mason

**The Family Group Sheets are provided as a basic framework for other family historians to build upon.*

Many of the families listed are ones that I had no direct contact with (no 'local knowledge') and am happy for others more closely associated with the various families to expand on and / or advise me of any information corrections/amendments that should be made.

Any feedback would be appreciated:

*John Malone
Cootamundra NSW Australia
Email: honeybugle66@gmail.com*